

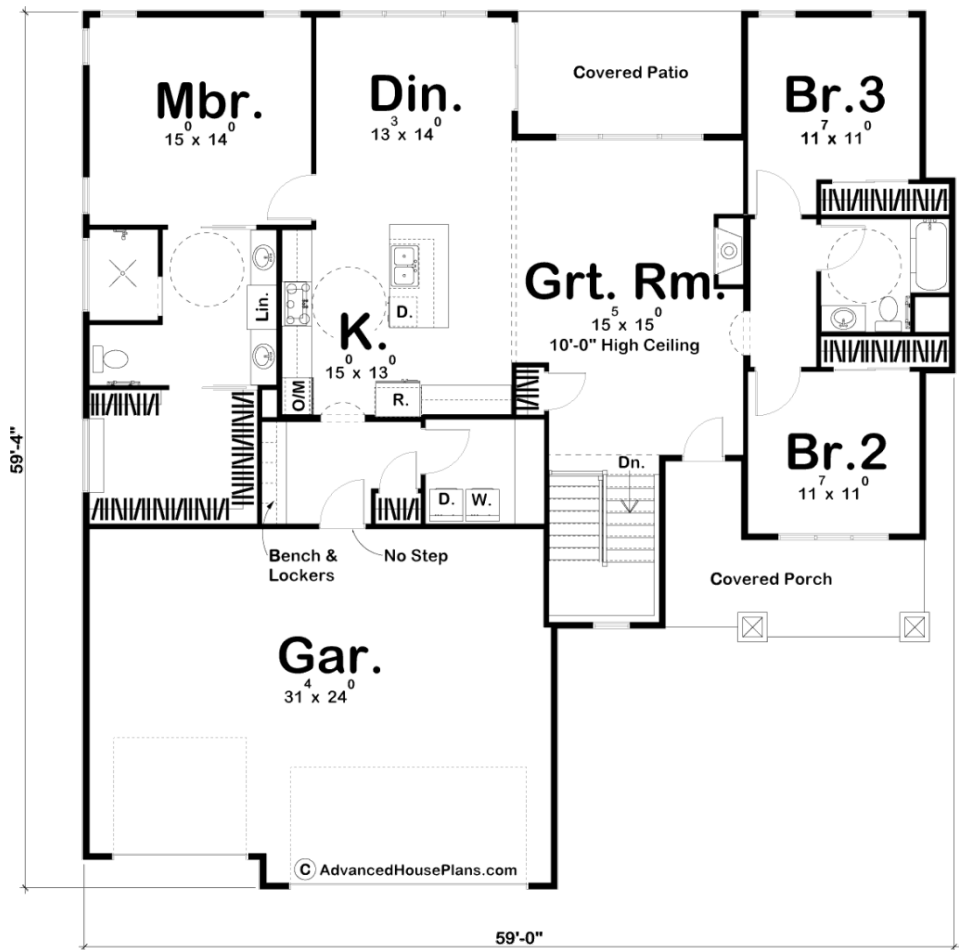

29368 - Ridgeway Data Sheet

1932 SQ FT	3 BEDS	2 BATHS	3 BAYS	59' 0" WIDE	60' 0" DEEP
---------------	-----------	------------	-----------	----------------	----------------



Construction Specs

Layout

Bedrooms

Bathrooms	2
Garage Bays	3
Square Footage	
Main Level	1932 Sq. Ft.
Garage	748 Sq. Ft.
Total Finished Area	1932 Sq. Ft.
Exterior Dimensions	
Width	59' 0"
Depth	60' 0"
Ridge Height	25'
<i>Calculated from main floor line</i>	
Default Construction Stats	
<i>Stats are unique to the individual plan.</i>	
Foundation Type	Basement
Exterior Wall Construction	2x4
Roof Pitches	8/12 primary 4/12 secondary
Foundation Wall Height	9'
Main Wall Height	9'

Plan Description

Tapered columns frame the inviting front porch on this craftsman-style one-story house plan. Just inside, an open arrangement of the great room, dining area, and kitchen is brightened by generous windows to the rear. The kitchen itself is graced with an island counter and plenty of storage space. A mudroom with benches and lockers separates the kitchen from the 3-car garage, with a practical no-step entry. The master suite is situated for privacy, tucked away from the main living areas with its spacious bath and roomy walk-in closet. The secondary bedrooms reside on the other side of the home, sharing a bath. At the rear, adjacent to bedroom 3, the great room and the dining area, a covered patio extends entertaining options to the outdoors. The Ridgeway house plan is designed specifically to be wheelchair friendly! We've taken care to ensure there's plenty of room to maneuver, 36" primary doors, and have even designed a zero-entry foundation detail to eliminate steps from the garage and front porch. This is a great plan for folks considering life in their elder years.