

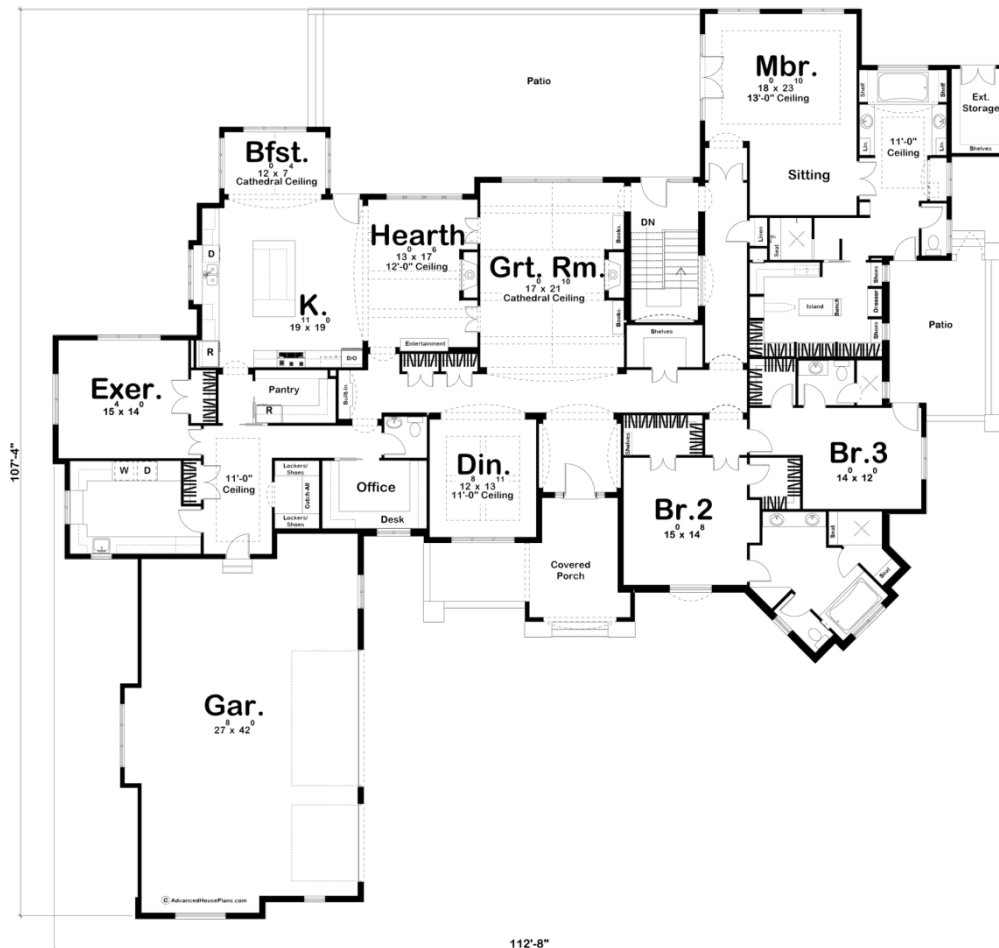

## 29390 - Prairie Pines Data Sheet

4853 SQ FT	3 BEDS	4 BATHS	3 BAYS	113' 0" WIDE	108' 0" DEEP
---------------	-----------	------------	-----------	-----------------	-----------------



## Construction Specs

## Layout

## Bedrooms

Bathrooms	4
Garage Bays	3
<b>Square Footage</b>	
Main Level	4853 Sq. Ft.
Garage	1145 Sq. Ft.
Total Finished Area	4853 Sq. Ft.
<b>Exterior Dimensions</b>	
Width	113' 0"
Depth	108' 0"
Ridge Height	35'
<i>Calculated from main floor line</i>	
<b>Default Construction Stats</b>	
<i>Stats are unique to the individual plan.</i>	
Foundation Type	Basement
Exterior Wall Construction	2x4
Roof Pitches	12/12
Foundation Wall Height	9'
Main Wall Height	10'

## Plan Description

Prairie Pines is a luxurious house plan, exquisitely designed and full of beautiful features and elegant surprises. Every inch of this home has been thoughtfully considered - this is truly a dream home of the highest order! With refined French Country styling from front to back, Prairie Pines is sure to stand out from the crowd. This gorgeous ranch home plan features finely detailed rooms, including a cathedral ceiling great room with decorative wood trusses. There is an informal breakfast nook as well as a formal dining room for special occasions. The Master Suite is impressive with a large tub, walk-in tile shower, and a large walk-in closet with plenty of storage space. Prairie Pines is designed with 10' 2x6 walls, with 12/12 roof pitches. The plan has a basement foundation with 9' walls.