

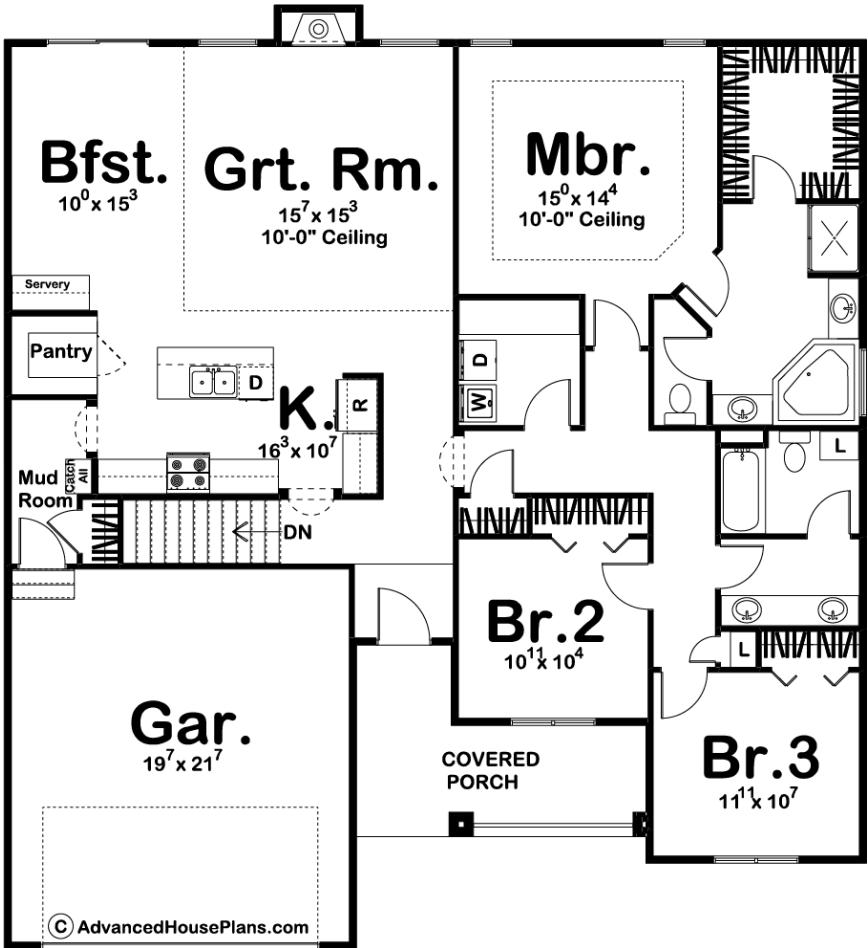

29294 - Overwood Data Sheet

|               |           |            |           |                |                |
|---------------|-----------|------------|-----------|----------------|----------------|
| 1877<br>SQ FT | 3<br>BEDS | 2<br>BATHS | 2<br>BAYS | 50' 0"<br>WIDE | 53' 0"<br>DEEP |
|---------------|-----------|------------|-----------|----------------|----------------|



Construction Specs

|        |
|--------|
| Layout |
|--------|

|          |   |
|----------|---|
| Bedrooms | 3 |
|----------|---|

|  |                     |
|--|---------------------|
| Bathrooms  | 2                   |
| Garage Bays  | 2                   |
| <b>Square Footage</b>  |                     |
| Main Level   | 1877 Sq. Ft.        |
| Garage   | 446 Sq. Ft.         |
| Total Finished Area  | 1877 Sq. Ft.        |
| <b>Exterior Dimensions</b>   |                     |
| Width  | 50' 0"              |
| Depth  | 53' 0"              |
| Ridge Height<br><i>Calculated from main floor line</i>                               | 25'                 |
| <b>Default Construction Stats</b><br><i>Stats are unique to the individual plan.</i> |                     |
| Foundation Type  | Basement            |
| Exterior Wall Construction   | 2x4                 |
| Roof Pitches   | 8/12 F-B, 12/12 S-S |
| Foundation Wall Height   | 9'                  |
| Main Wall Height   | 9'                  |

## Plan Description

A covered front porch and a pair of gables establish a sense of comfort on this 1,877 sq. ft., 1-story house plan. Inside, a few steps bring guests into the great room, with its fireplace, views to the rear and boundary-defining 10-foot-high ceiling. The kitchen and breakfast area lie open to the great room for comfortable entertaining. The kitchen itself is well-appointed, with an island work station, generous counter space, and a walk-in pantry. The breakfast area, which accesses the outside through sliding doors, features a handy servery counter. Just off the kitchen, a mud room with coat closet accesses the home's 2-car, front-load garage. All sleeping quarters reside on the other side of the home, where the master suite is tucked away for privacy. Its bath area -- offering amenities usually found in much larger homes -- includes his-and-her vanities, a corner soaking tub, compartmented toilet and a sizeable walk-in closet. Bedrooms 2 and 3 are separated from the master suite for privacy. Both secondary bedrooms share a central hall bath that features a double sink vanity that lies outside the bath area.