

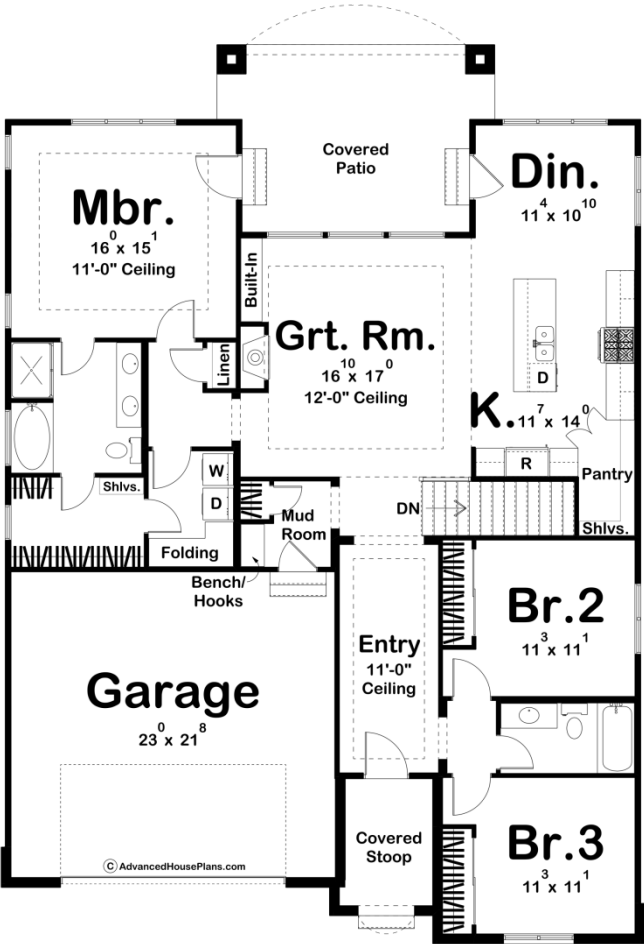

30146 - Oaks Lane Data Sheet

1789 SQ FT	3 BEDS	2 BATHS	2 BAYS	45' 0" WIDE	63' 0" DEEP
---------------	-----------	------------	-----------	----------------	----------------



Construction Specs

Layout
--------

Bedrooms

Bathrooms	2
Garage Bays	2
<b>Square Footage</b>	
Main Level	1789 Sq. Ft.
Covered Area	305 Sq. Ft.
Garage	520 Sq. Ft.
Total Finished Area	1789 Sq. Ft.
<b>Exterior Dimensions</b>	
Width	45' 0"
Depth	63' 0"
<b>Default Construction Stats</b> <i>Stats are unique to the individual plan.</i>	
Foundation Type	Basement
Exterior Wall Construction	2x4
Roof Pitches	8/12 Primary
Foundation Wall Height	9'
Main Wall Height	10'

## Plan Description

The Oaks Lane plan is a stunning Modern Farmhouse with an excellent floor plan to match! The exterior combines board and batten siding, brick, wood garage doors, and metal roof accents to give this home excellent curb appeal. A covered stoop leads guests into the wonderful entry way with its decorative trayed ceiling. Two bedrooms can be found right off the main entry. Further into the home, the kitchen, great room, and dining room are arranged in a wonderful open layout. The kitchen includes a large island with a snack bar and a walk-in pantry. The great room is warmed by a fireplace that includes built-in bookshelves. The exquisite master suite is arranged on the left side of the home. The master bedroom lies under a decorative trayed ceiling. The master bathroom includes a dual vanity, a walk-in shower, a soaking tub, and a large walk-in closet with access to the laundry room. The home's 2-car garage leads into the home through a convenient mud room.