

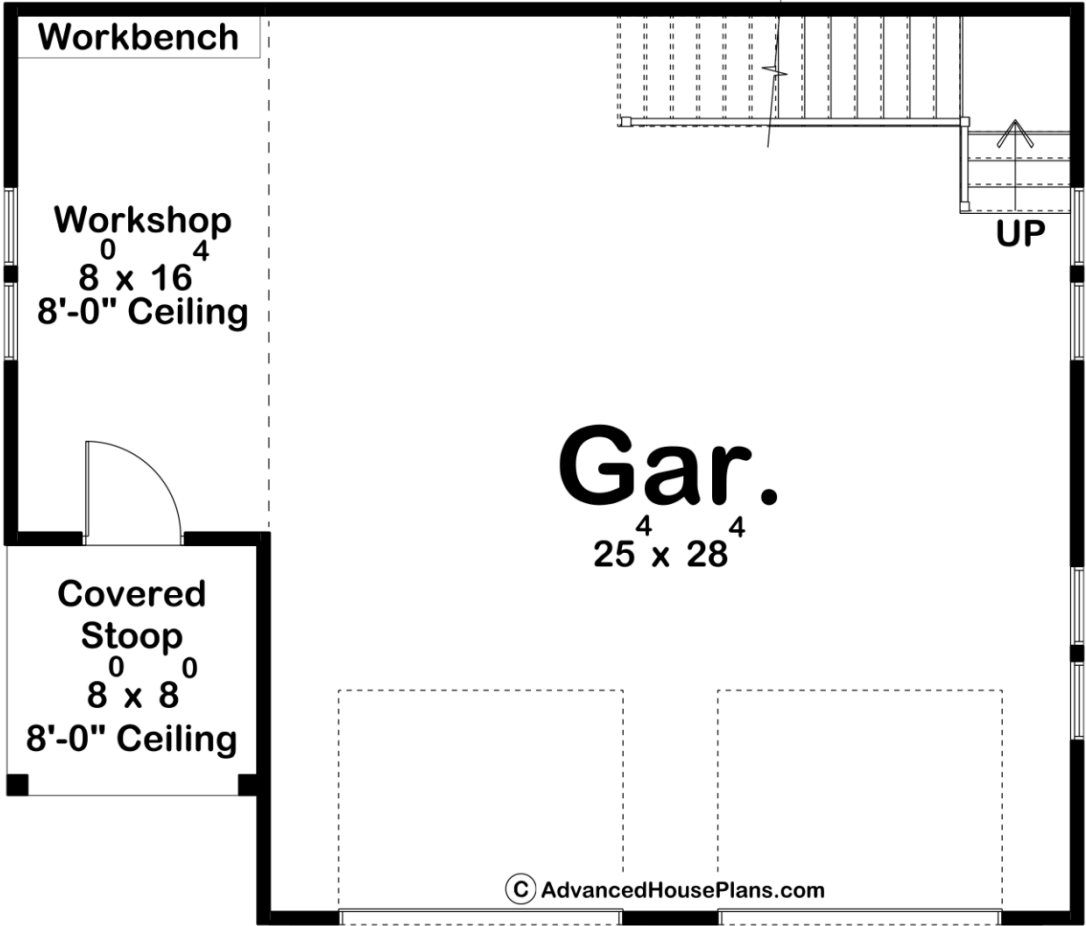

30448 - McAlpine Data Sheet

0 SQ FT	0 BEDS	0 BATHS	2 BAYS	34' 0" WIDE	29' 0" DEEP
------------	-----------	------------	-----------	----------------	----------------

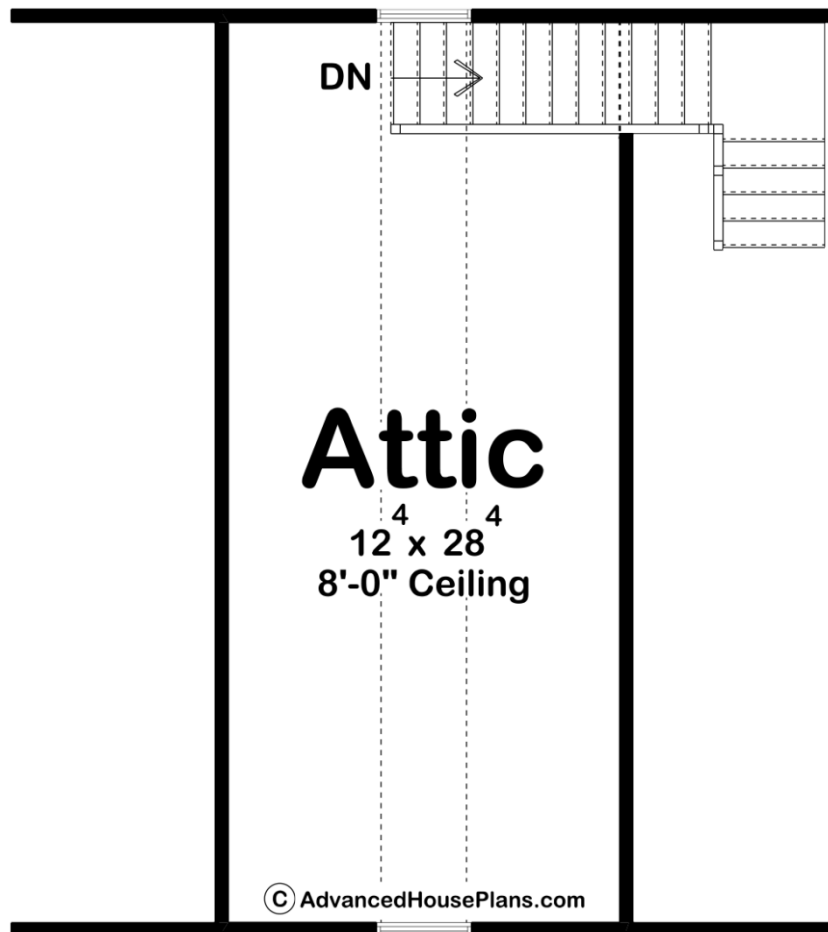



## Construction Specs

### Layout

Garage Bays 2

### Square Footage

Covered Area 64 Sq. Ft.

Garage 890 Sq. Ft.

### Exterior Dimensions

Width 34' 0"

Depth 29' 0"

### Default Construction Stats

*Stats are unique to the individual plan.*

Foundation Type Slab

Exterior Wall Construction 2x4

Roof Pitches Primary 9/12, Secondary 4/12, 6/12

Main Wall Height 10'

## Plan Description

▪

Introducing the McAlpine, a versatile haven of functionality and potential – a 2-car garage featuring a workshop and an expansive attic space. This meticulously designed structure is tailored to meet the diverse needs of homeowners, offering a seamless blend of practicality and adaptability. The exterior of the garage is a testament to classic design, with a tasteful facade that complements various architectural styles. Sturdy garage doors open to reveal a spacious interior, accommodating two vehicles comfortably and providing a secure shelter against the elements. The workshop, intelligently integrated into the layout, is equipped with a durable workbench, ample storage solutions, and strategically placed power outlets to facilitate a range of DIY projects. Ascend the well-crafted staircase to discover the hidden gem of this structure – the attic space. Bathed in natural light streaming through well-positioned windows, the attic presents itself as a versatile area awaiting your personal touch. This garage is more than just a storage facility; it is a dynamic and adaptable extension of your home. Whether you're a car enthusiast, a DIY hobbyist, or in need of extra living space, this structure effortlessly accommodates your evolving needs, ensuring that your home evolves with you.