

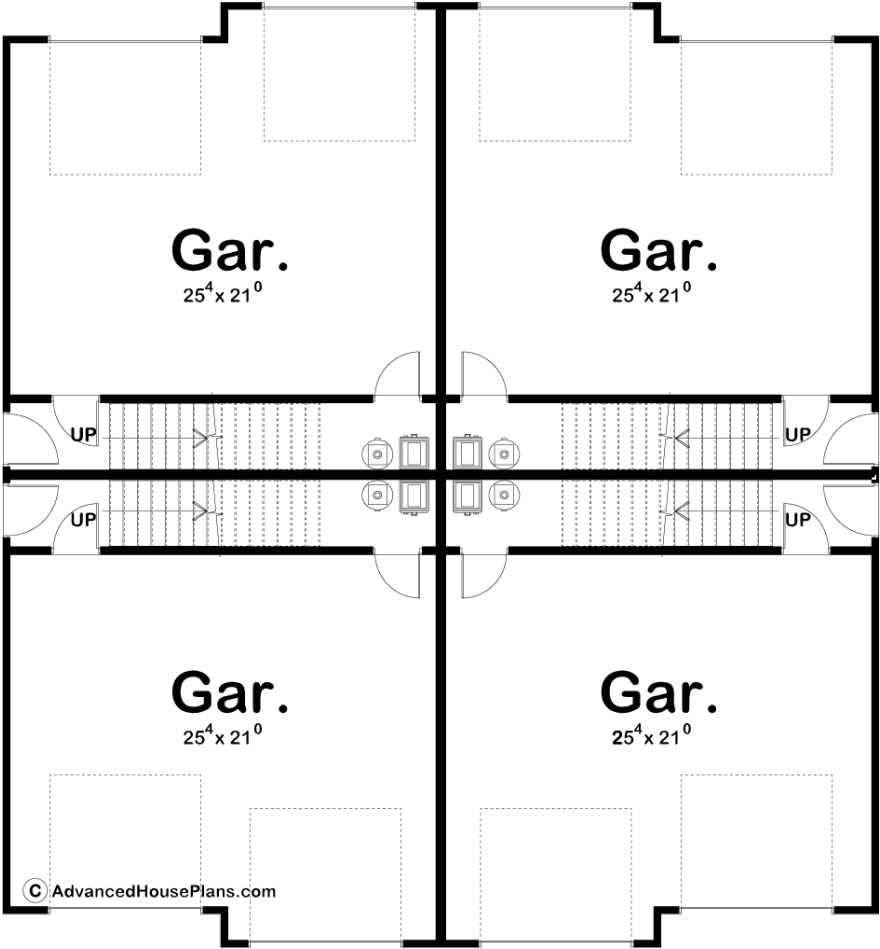

29341 - Krueger Data Sheet

708 SQ FT	1 BEDS	1 BATHS	2 BAYS	52' 0" WIDE	56' 0" DEEP
--------------	-----------	------------	-----------	----------------	----------------

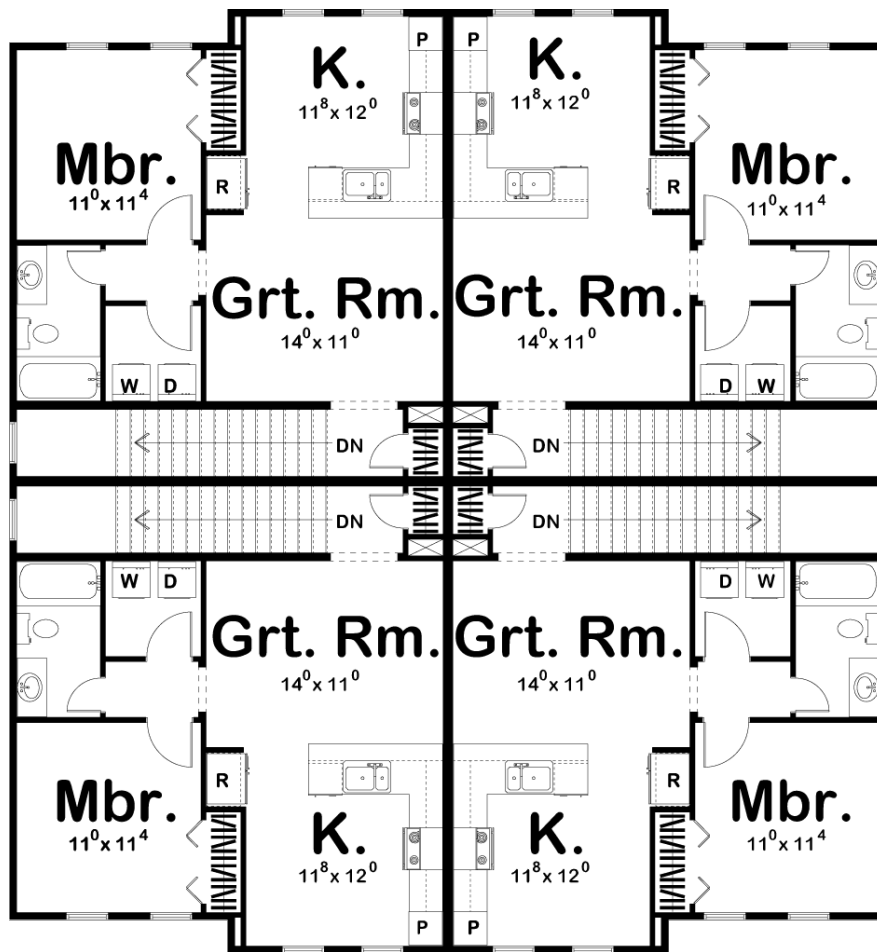



Construction Specs

Layout

Bedrooms	1
Bathrooms	1
Garage Bays	2

Square Footage

Second Level	708 Sq. Ft.
Garage	593 Sq. Ft.
Total Finished Area	708 Sq. Ft.

Exterior Dimensions

Width	52' 0"
Depth	56' 0"
Ridge Height	23'
<i>Calculated from main floor line</i>	

Default Construction Stats

Stats are unique to the individual plan.

Foundation Type	Slab
Exterior Wall Construction	2x4
Roof Pitches	6/12 Primary, 10/12 Secondary
Main Wall Height	9'
Second Wall Height	8'

Plan Description

A 2-car garage grants entry into to each of the loft apartment-style residences that lie above, in this quad-plex, multi-family house plan. Once inside, guests are welcomed into the great room, which openly interacts with the kitchen. The kitchen's L-shaped counter supports an efficient work area and breakfast bar. Just off the great room, an alcove provides access to the master bedroom, laundry room, and bath. Residents will appreciate the privacy afforded to the master suite, by its thoughtful placement on the corner of the structure. This arrangement provides maximum separation of the bedrooms of all neighboring residents. As always any Advanced House Plans home plan can be customized to fit your needs with our alteration department. Whether you need to add another garage stall, change the front elevation, stretch the home larger or just make the home plan more affordable for your budget we can do that and more for you at Ahp. Unless you purchase an unlimited use license or a multi-use license you may only build one home from a set of plans. Plans cannot be re-sold.