

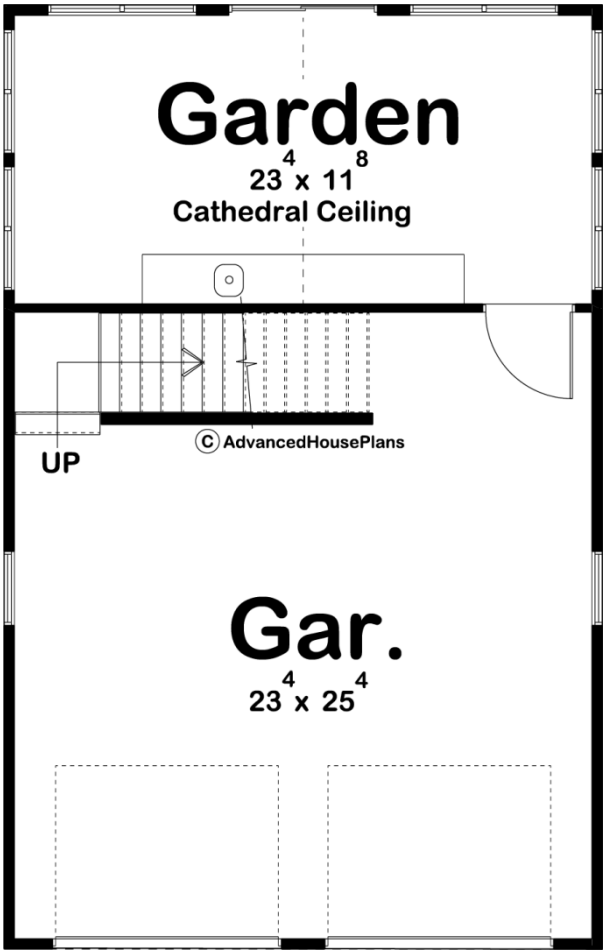

29376 - Kistler Data Sheet

730 SQ FT	0 BEDS	0 BATHS	2 BAYS	24' 0" WIDE	38' 0" DEEP
--------------	-----------	------------	-----------	----------------	----------------

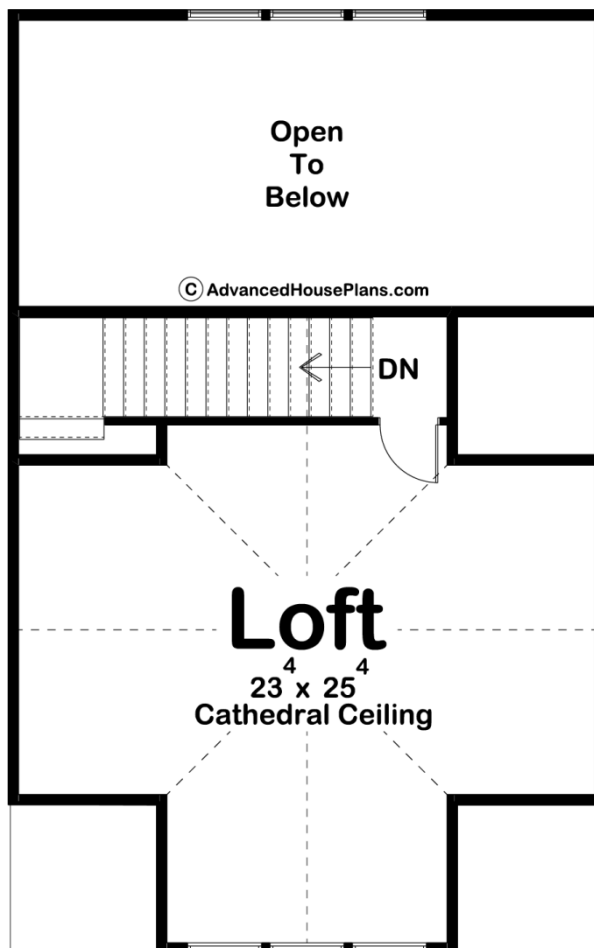



Construction Specs

Layout

Garage Bays	2
-------------	---

Square Footage

Main Level	288 Sq. Ft.
Second Level	442 Sq. Ft.
Garage	624 Sq. Ft.
Total Finished Area	730 Sq. Ft.

Exterior Dimensions

Width	24' 0"
Depth	38' 0"

Default Construction Stats

Stats are unique to the individual plan.

Foundation Type	Slab
Exterior Wall Construction	2x4
Roof Pitches	12/12 Primary

Main Wall Height	9'
Second Wall Height	6'

Plan Description

Kistler is a 2-story traditional garage built on a slab foundation. There is an attic space above the garage and a 2-story garden room in the rear. The second story walls are built at 6' and the ceiling slopes up to approximately 10'. The garden room has windows on 3 sides and a large sliding patio door on the rear.