

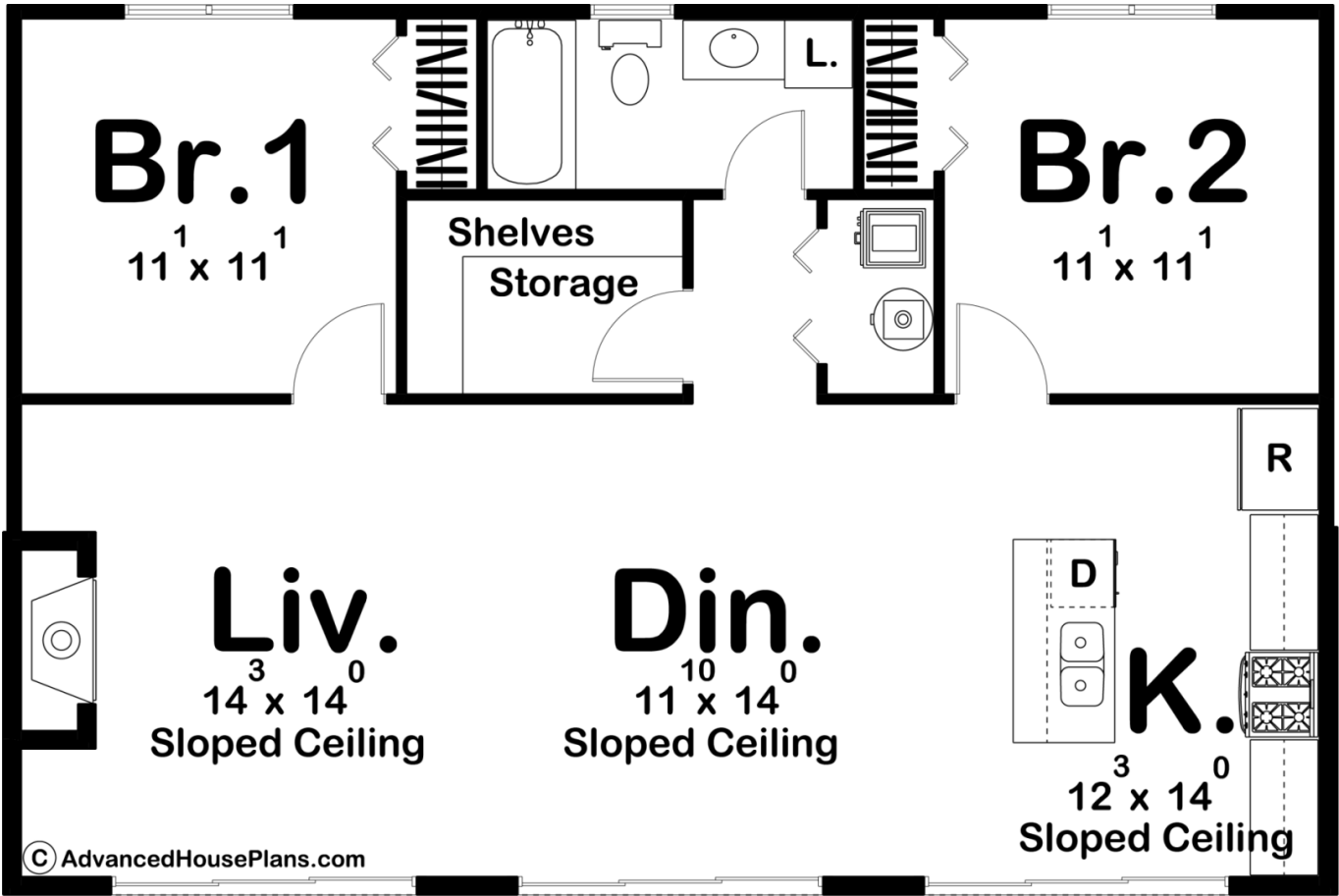

29533 - Hickman Data Sheet

1014 SQ FT	2 BEDS	1 BATHS	0 BAYS	39' 0" WIDE	26' 0" DEEP
---------------	-----------	------------	-----------	----------------	----------------



Construction Specs

Layout
--------

Bedrooms

Bathrooms	1
-----------	---

**Square Footage**

Main Level	1014 Sq. Ft.
Total Finished Area	1014 Sq. Ft.

**Exterior Dimensions**

Width	39' 0"
Depth	26' 0"

**Default Construction Stats**

*Stats are unique to the individual plan.*

Foundation Type	Slab
Exterior Wall Construction	2x6
Roof Pitches	2/12 Primary
Main Wall Height	9'

**Plan Description**

This modern style cabin plan makes for the perfect family getaway. The Hickman has full kitchen with an island and breakfast bar that flows into a dining room and a family room with a fireplace. Both bedrooms share a centrally located bathroom.