

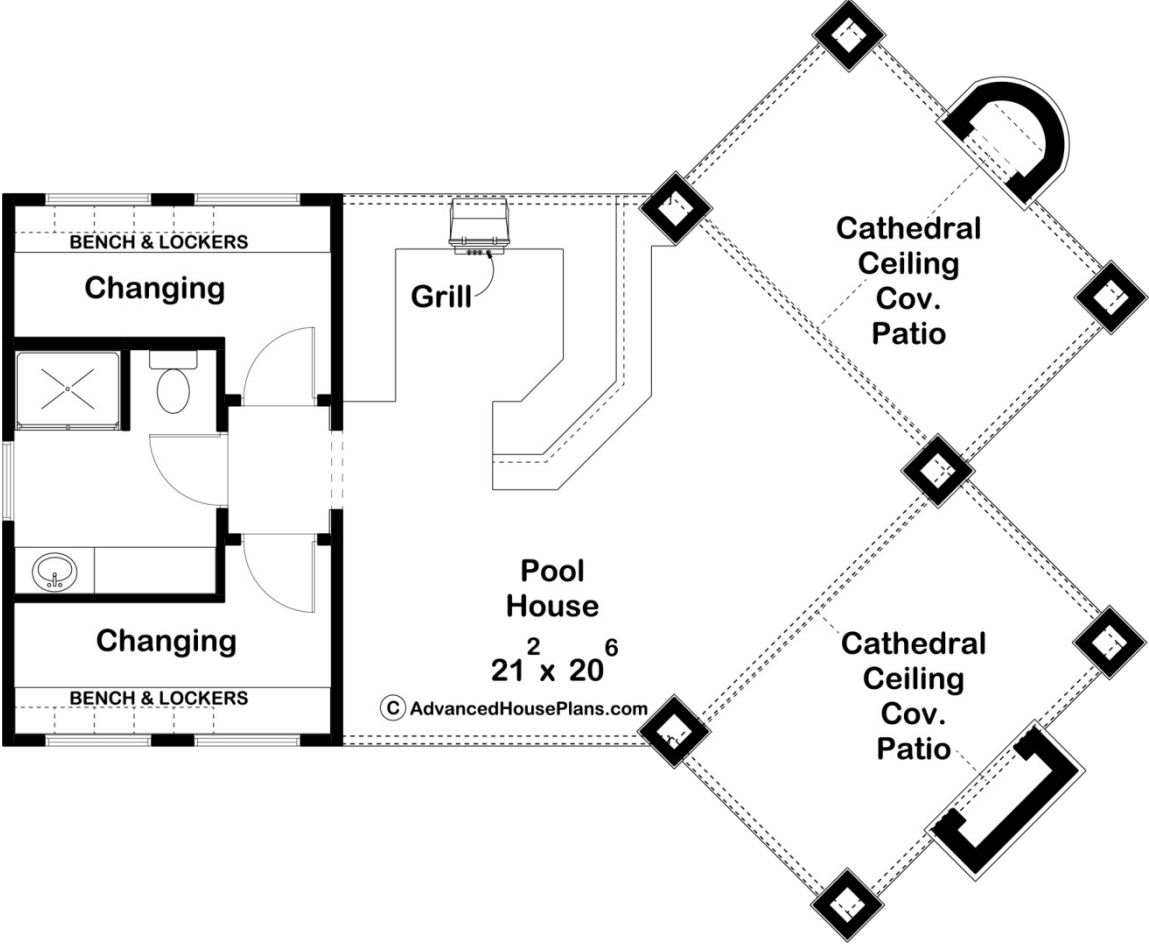

29404 - Havana Data Sheet

262 SQ FT	0 BEDS	1 BATHS	0 BAYS	43' 0" WIDE	36' 0" DEEP
--------------	-----------	------------	-----------	----------------	----------------



Construction Specs

Layout

Bathrooms

### Square Footage

Main Level	262 Sq. Ft.
Covered Area	658 Sq. Ft.
Total Finished Area	262 Sq. Ft.

### Exterior Dimensions

Width	43' 0"
Depth	36' 0"

### Default Construction Stats

*Stats are unique to the individual plan.*

Foundation Type	Slab
Exterior Wall Construction	2x4

## Plan Description

This pool house design is great for any pool owner. The Havana plan welcomes everyone from all directions. Two gable ends make for a spacious feel with cathedral ceilings over both covered patios. This space is great for entertaining when the sun reaches its peak. The U-shaped counter gives any cook enough space for prepping and is great for any backyard BBQ. On the inside, this unique pool house design gives owners a storage place for towels and other belongings in the "locker room" areas. Perfect for all guests needing a place to slip into their pool attire. Located in between the two changing areas is a 3/4 bath. The outdoor fireplace makes this pool house plan great for any time of the year. Be sure to check out our other pool houses. As always any of our plans at Advanced House Plans can be customized to fit your needs with our alteration department. Whether you need to change the front elevation style, stretch it larger or just make the plan more affordable for your budget we can do that and more for you at Ahp.