

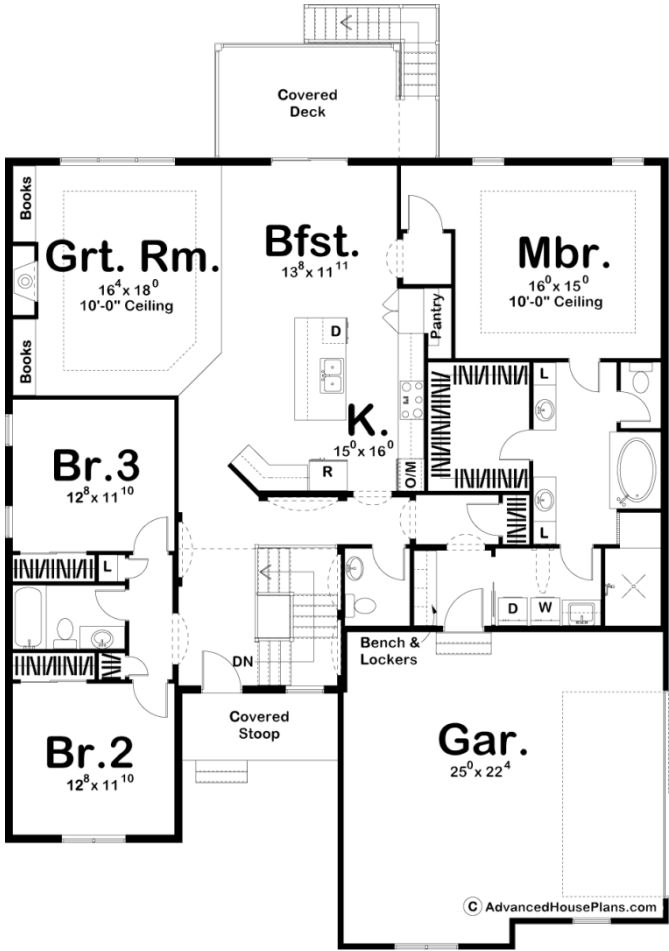

29317 - Greenberg Data Sheet

| | | | | | |
|---------------|-----------|------------|-----------|----------------|----------------|
| 2195 SQ FT | 3 BEDS | 3 BATHS | 2 BAYS | 52' 0" WIDE | 62' 0" DEEP |
|---------------|-----------|------------|-----------|----------------|----------------|



Construction Specs

| |
|--------|
| Layout |
|--------|

Bedrooms

| | |
|--|--------------|
| Bathrooms | 3 |
| Garage Bays | 2 |
| Square Footage | |
| Main Level | 2195 Sq. Ft. |
| Garage | 607 Sq. Ft. |
| Total Finished Area | 2195 Sq. Ft. |
| Exterior Dimensions | |
| Width | 52' 0" |
| Depth | 62' 0" |
| Ridge Height <i>Calculated from main floor line</i> | 25' |
| Default Construction Stats <i>Stats are unique to the individual plan.</i> | |
| Foundation Type | Basement |
| Exterior Wall Construction | 2x4 |
| Foundation Wall Height | 9' |
| Main Wall Height | 9' |

Plan Description

Features include: * 2 car side entry garage * A generous Master suite offers a walk-in shower, whirlpool tub and an expansive closet * The large kitchen offers plenty of storage and open entertaining with views into the Great Room * The Mud Room features a bench and locker set