

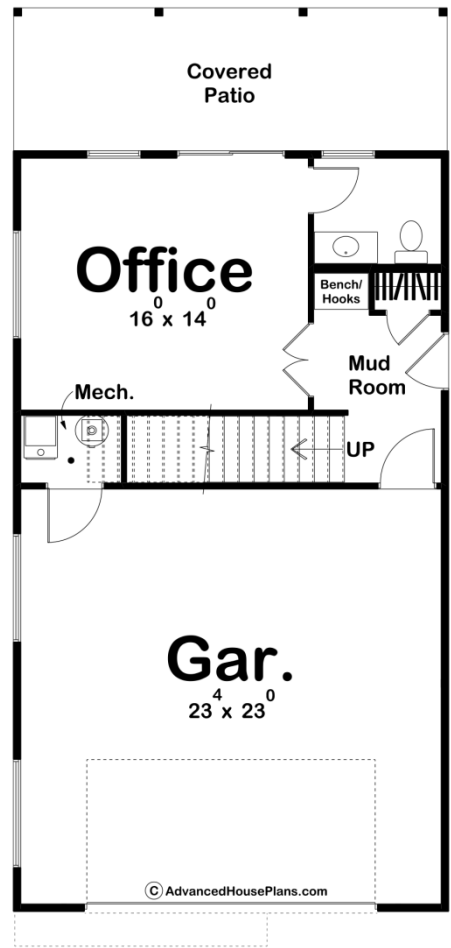

30272 - Goodwin Data Sheet

1422 SQ FT	2 BEDS	2 BATHS	2 BAYS	24' 0" WIDE	50' 0" DEEP
---------------	-----------	------------	-----------	----------------	----------------

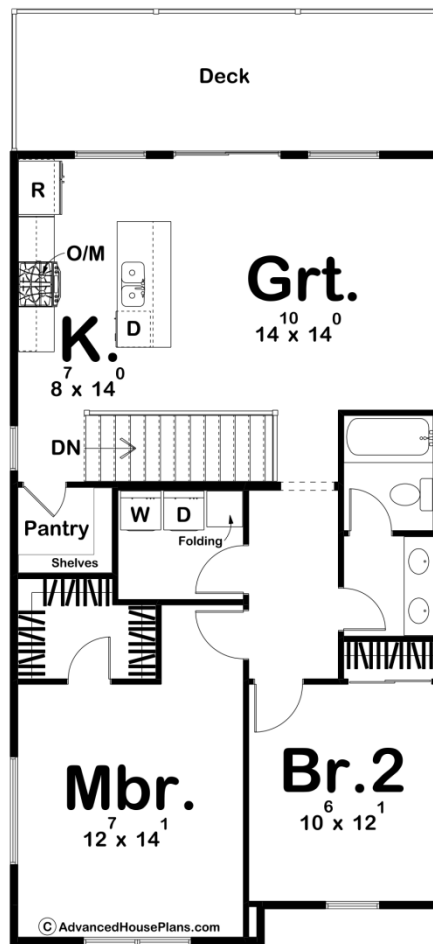



## Construction Specs

### Layout

Bedrooms	2
Bathrooms	2
Garage Bays	2

### Square Footage

Main Level	425 Sq. Ft.
Second Level	997 Sq. Ft.
Garage	560 Sq. Ft.
Total Finished Area	1422 Sq. Ft.

### Exterior Dimensions

Width	24' 0"
Depth	50' 0"

### Default Construction Stats

*Stats are unique to the individual plan.*

Foundation Type	Slab
-----------------	------

Exterior Wall Construction	2x4
Roof Pitches	Primary 4/12, Secondary 3/12
Main Wall Height	10'
Second Wall Height	8'

## Plan Description

The Goodwin plan is a modern style carriage house that boasts 1422 square feet, 2 beds and 2 baths. The exterior of this home is unique with mixtures of board and batten siding, stone, and vinyl siding. The glass garage and color combination gives this plan a modern feel, while also providing hints of a modern farmhouse. Heading in through the two car garage welcomes you to a mudroom as well as an office and powder bath. This area is perfect for those who work from home and want a space away from their living quarters while not having to travel. Head upstairs to find the additional living space, including the great room, kitchen, a bathroom, and two bedrooms. A walk-in pantry and laundry room can also be found here, as well as a beautiful island in the kitchen and a walk-in closet in the master bedroom.