

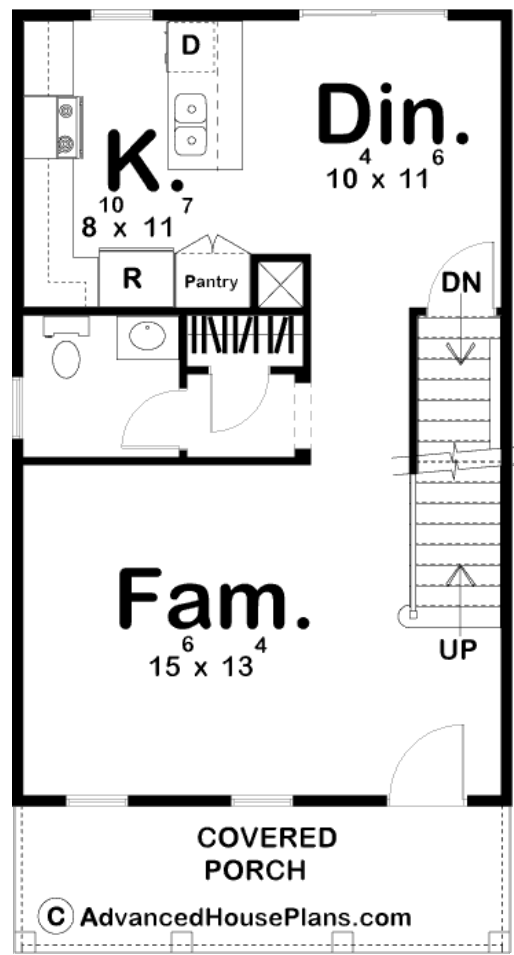

29361 - Giovanni Data Sheet

1228 SQ FT	2 BEDS	3 BATHS	0 BAYS	20' 0" WIDE	38' 0" DEEP
---------------	-----------	------------	-----------	----------------	----------------

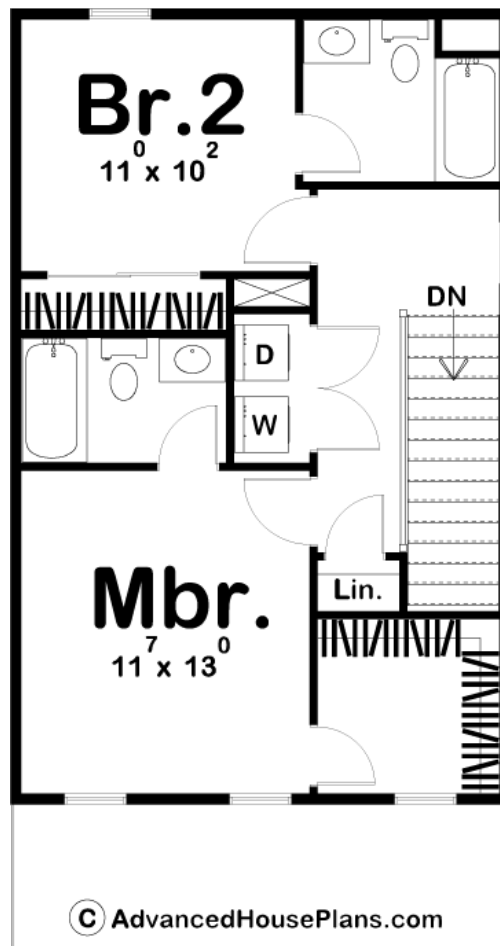



Construction Specs

Layout

Bedrooms	2
Bathrooms	3

Square Footage

Main Level	640 Sq. Ft.
Second Level	588 Sq. Ft.
Total Finished Area	1228 Sq. Ft.

Exterior Dimensions

Width	20' 0"
Depth	38' 0"
Ridge Height <i>Calculated from main floor line</i>	29'

Default Construction Stats

Stats are unique to the individual plan.

Foundation Type	Basement
-----------------	----------

Exterior Wall Construction	2x4
Roof Pitches	Primary 10/12, Secondary 4/12
Foundation Wall Height	9'
Main Wall Height	9'
Second Wall Height	8'

Plan Description

Perfect for in-fill and narrow lots, this 20-foot-wide house plan features a full, covered front porch. Inside, guests are immediately greeted by the family room. An adjacent alcove offers the use of a coat closet and powder bath. To the rear, the dining area shares an open arrangement with the kitchen, which features a breakfast island, pantry and practical counter space. Upstairs, the master bedroom features a sizeable walk-in closet with window. A wall separates its bath area from the centrally located laundry. Just off the second-floor landing, bedroom 2 enjoys its own private bath. Check out our other small house plans! As always any Advanced House Plans home plan can be customized to fit your needs with our alteration department. Whether you need to add another garage stall, change the front elevation, stretch the home larger or just make the home plan more affordable for your budget we can do that and more for you at Ahp.