

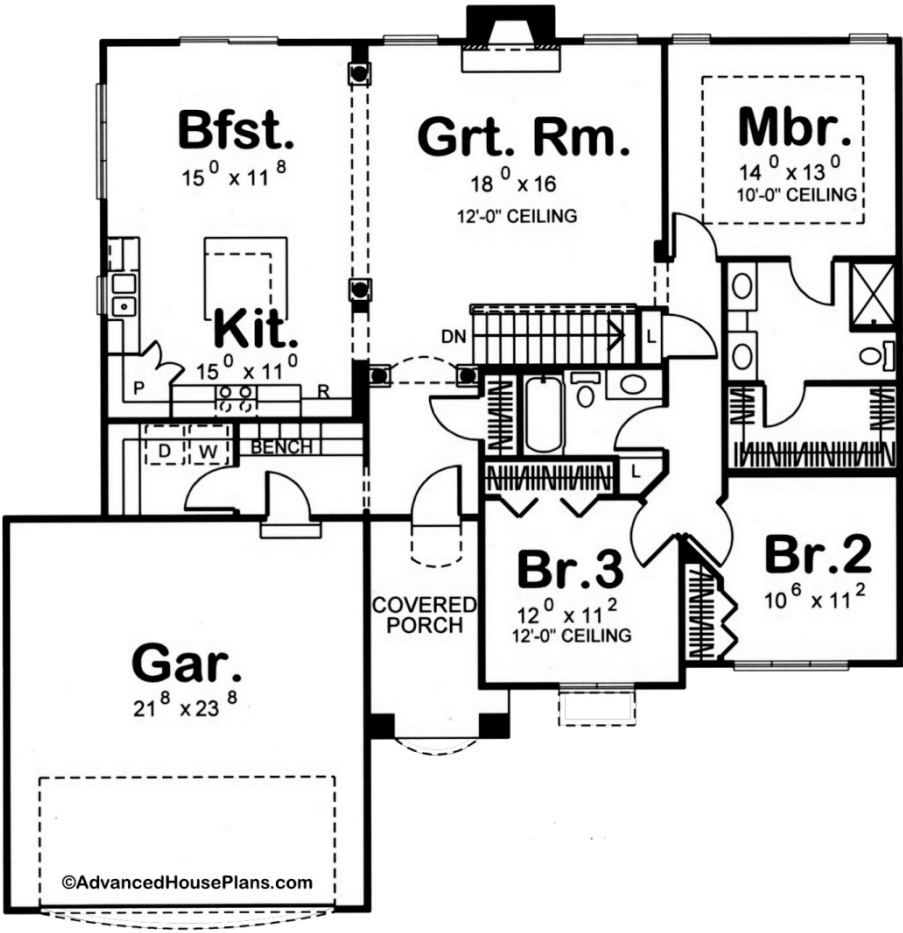

29048 - Freeman Data Sheet

1688 SQ FT	3 BEDS	2 BATHS	2 BAYS	55' 0" WIDE	54' 0" DEEP
---------------	-----------	------------	-----------	----------------	----------------



Construction Specs

Layout

Bedrooms

Bathrooms	2
Garage Bays	2
Square Footage	
Main Level	1688 Sq. Ft.
Garage	538 Sq. Ft.
Total Finished Area	1688 Sq. Ft.
Exterior Dimensions	
Width	55' 0"
Depth	54' 0"
Ridge Height	25'
<i>Calculated from main floor line</i>	
Default Construction Stats	
<i>Stats are unique to the individual plan.</i>	
Foundation Type	Basement
Exterior Wall Construction	2x4
Roof Pitches	6/12 F-B, 10/12 S-S
Foundation Wall Height	9'
Main Wall Height	9'

Plan Description

A welcoming stone arched entryway leads you into this one-story traditional home and guides you towards the great room. The square kitchen island and corner walk-in pantry provide convenience for the home chef. The lockers and separate laundry area by the garage entryway are helpful as well. This home has three bedrooms and two baths.