

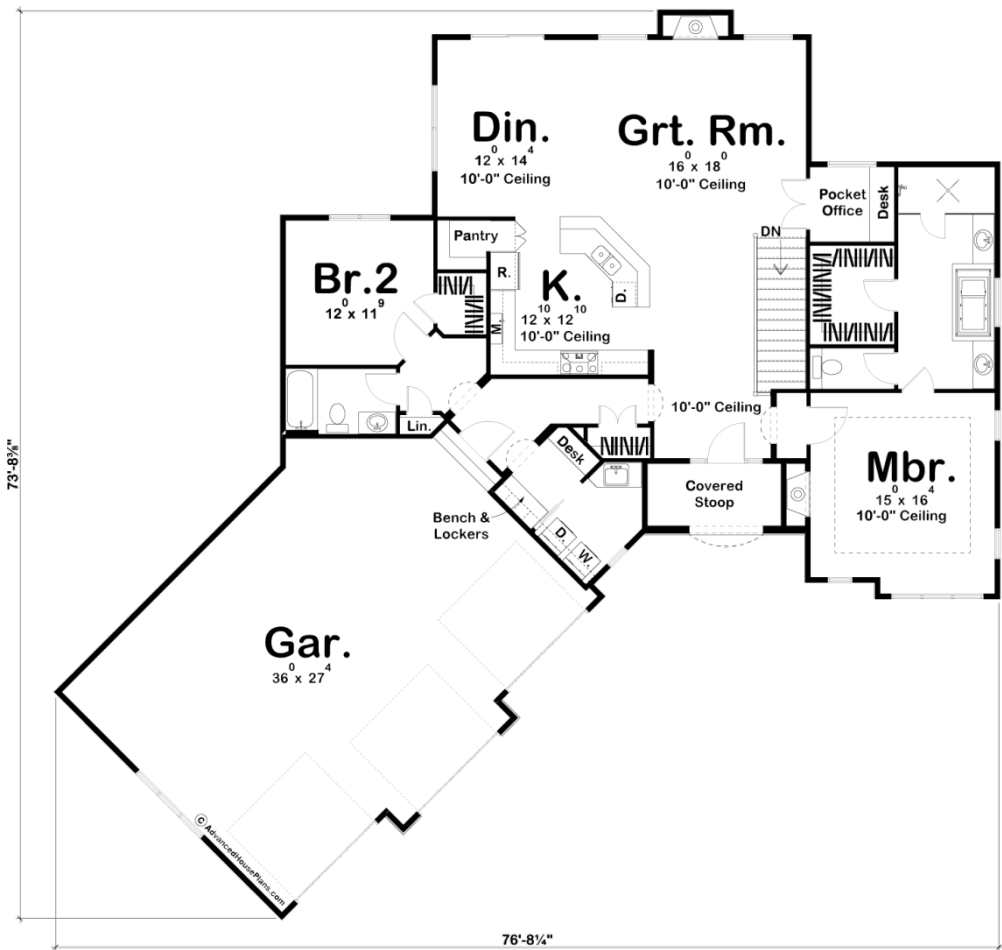

29384 - Foxborough Data Sheet

1904 SQ FT	2 BEDS	2 BATHS	3 BAYS	77' 0" WIDE	74' 0" DEEP
---------------	-----------	------------	-----------	----------------	----------------



Construction Specs

Layout

Bedrooms

Bathrooms	2
Garage Bays	3
<b>Square Footage</b>	
Main Level	1904 Sq. Ft.
Garage	958 Sq. Ft.
Total Finished Area	1904 Sq. Ft.
<b>Exterior Dimensions</b>	
Width	77' 0"
Depth	74' 0"
Ridge Height	24'
<i>Calculated from main floor line</i>	
<b>Default Construction Stats</b>	
<i>Stats are unique to the individual plan.</i>	
Foundation Type	Basement
Exterior Wall Construction	2x4
Roof Pitches	8/12 front-back 12/12 sides
Foundation Wall Height	9'
Main Wall Height	9'

## Plan Description

With a gorgeous cottage-style front elevation, and a spacious, open floor plan, the Foxborough sets itself apart. We've blended stucco, stone, and wood, to create an almost magical appeal. The look is complemented with decorative wood brackets, tudor-style trim, steep roof pitches, and a prominent stone fireplace that brings it all together. This house plan features a very open floor plan, massive 3 car garage, and a kitchen that is just as suited for entertaining as it is for cooking. The Master Suite has 10' ceiling, and a large bathroom with an oversized tub and walk-in tile shower.