

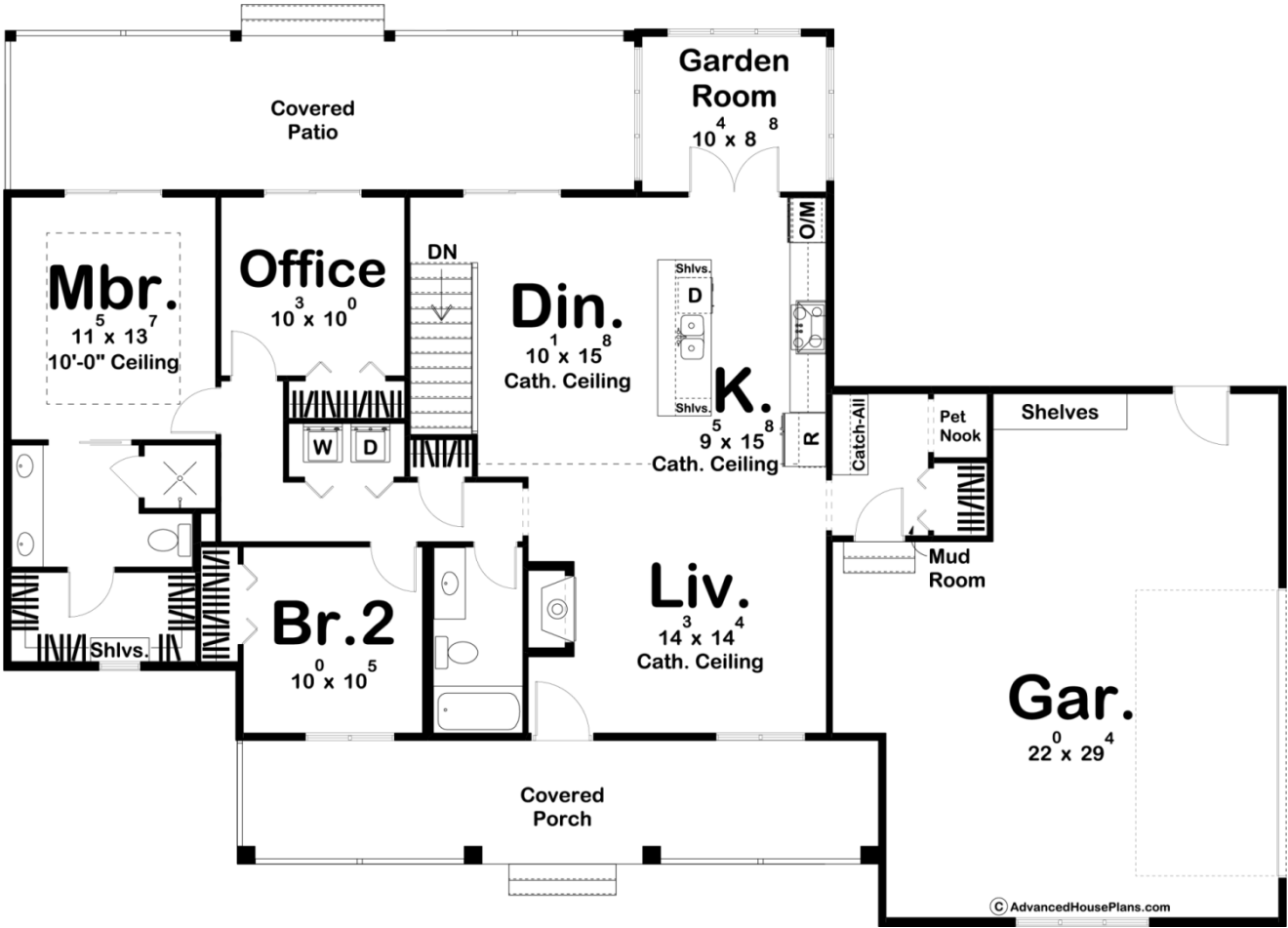

29956 - Elowen Data Sheet

1542 SQ FT	2 BEDS	2 BATHS	2 BAYS	66' 0" WIDE	46' 0" DEEP
---------------	-----------	------------	-----------	----------------	----------------



Construction Specs

Layout

Bedrooms

Bathrooms	2
Garage Bays	2
Square Footage	
Main Level	1542 Sq. Ft.
Garage	587 Sq. Ft.
Total Finished Area	1542 Sq. Ft.
Exterior Dimensions	
Width	66' 0"
Depth	46' 0"
Default Construction Stats	
<i>Stats are unique to the individual plan.</i>	
Foundation Type	Basement
Exterior Wall Construction	2x4
Roof Pitches	8/12 Primary, 4/12 Secondary
Foundation Wall Height	9'
Main Wall Height	9'

Plan Description

The Elowen plan is an elegant Craftsman style ranch house plan. The exterior is highlighted by a side-load garage and a large covered porch. Just inside the home, the living room, kitchen, and dining room flow seamlessly in an open layout and lie under a soaring cathedral ceiling. The living room is warmed by a cozy fireplace. The kitchen includes an island with built-in shelving and a snack bar. Just off the kitchen, you'll find a relaxing garden room. The master suite includes his/her vanities, a walk-in shower, and a walk-in closet with built-in shelving. Just outside the master suite is a practical home office that could be used as a 3rd bedroom. The 2 car side load garage accesses the home through a convenient mudroom that includes a coat closet, catch-all, and a pet nook.