

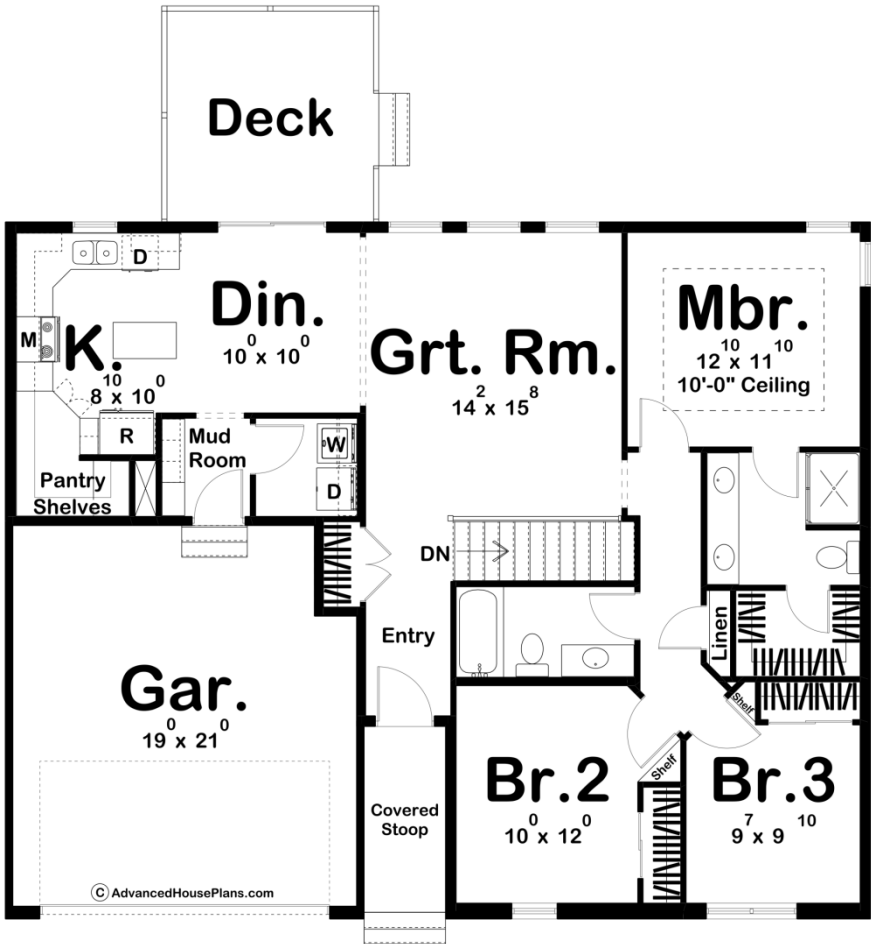

30106 - Crofton Data Sheet

1353 SQ FT	3 BEDS	2 BATHS	2 BAYS	47' 8" WIDE	50' 0" DEEP
---------------	-----------	------------	-----------	----------------	----------------



Construction Specs

Layout

Bedrooms

Bathrooms	2
Garage Bays	2
Square Footage	
Main Level	1353 Sq. Ft.
Garage	405 Sq. Ft.
Total Finished Area	1353 Sq. Ft.
Exterior Dimensions	
Width	47' 8"
Depth	50' 0"
Default Construction Stats	
<i>Stats are unique to the individual plan.</i>	
Foundation Type	Basement
Exterior Wall Construction	2x4
Roof Pitches	8/12 Primary
Foundation Wall Height	9'
Main Wall Height	9'

Plan Description

The Crofton plan makes great use of it's small space to create a fantastic simple house. As you walk through the entryway you will see a large great room with a windows to the rear of the home. The dining room flows into a beautiful kitchen with an island and a walk in pantry. On the right side of the home you will find a wonderful master suite complete with his/her vanities, a walk in shower and a walk in closet. Bedrooms 2 and 3 share a centrally located hall bathroom. The house is also accessible from the 2 car garage through a simple and practical mudroom with lockers. This house is sure to impress at it's small 1353 sq. ft. footprint.