

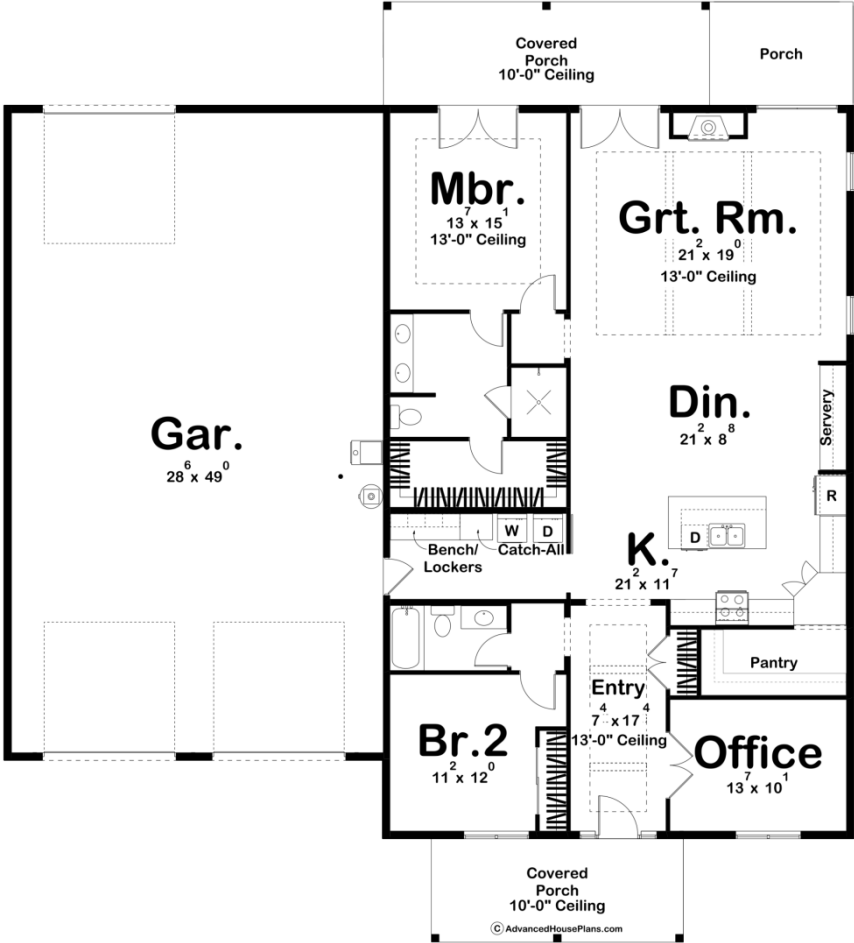

30279 - Chamberlain Data Sheet

2016 SQ FT	2 BEDS	2 BATHS	3 BAYS	65' 0" WIDE	72' 0" DEEP
---------------	-----------	------------	-----------	----------------	----------------



Construction Specs

Layout

Bedrooms

Bathrooms	2
Garage Bays	3
Square Footage	
Main Level	2016 Sq. Ft.
Covered Area	443 Sq. Ft.
Garage	1450 Sq. Ft.
Total Finished Area	2016 Sq. Ft.
Exterior Dimensions	
Width	65' 0"
Depth	72' 0"
Default Construction Stats <i>Stats are unique to the individual plan.</i>	
Foundation Type	Slab
Exterior Wall Construction	2x6
Roof Pitches	Primary 3/12, Secondary 4/12
Main Wall Height	12'

Plan Description

The Chamberlain plan is a modern style barndominium house plan with a beautiful dark exterior and wood accents. It boasts 2016 square feet, 2 bedrooms and 2 bathrooms. A covered 10' ceiling porch brings you into a lengthy 13' tall entryway and an office right off to the side. Heading straight in brings you into a large open concept area, complete with a spacious walk-in pantry, a severy, and kitchen island. The great room provides a tall 13' ceiling with connection to a covered 10' ceiling porch out to the rear of the home. The bedrooms can be found off the main living areas, the master complete with a 13' ceiling, access to the covered porch, a spacious bathroom with double vanities, separate shower and large walk-in closet. Bedroom two shares a hallway bathroom with guests and is right off the mudroom and laundry area that leads out to a large three-car garage and workshop area.