

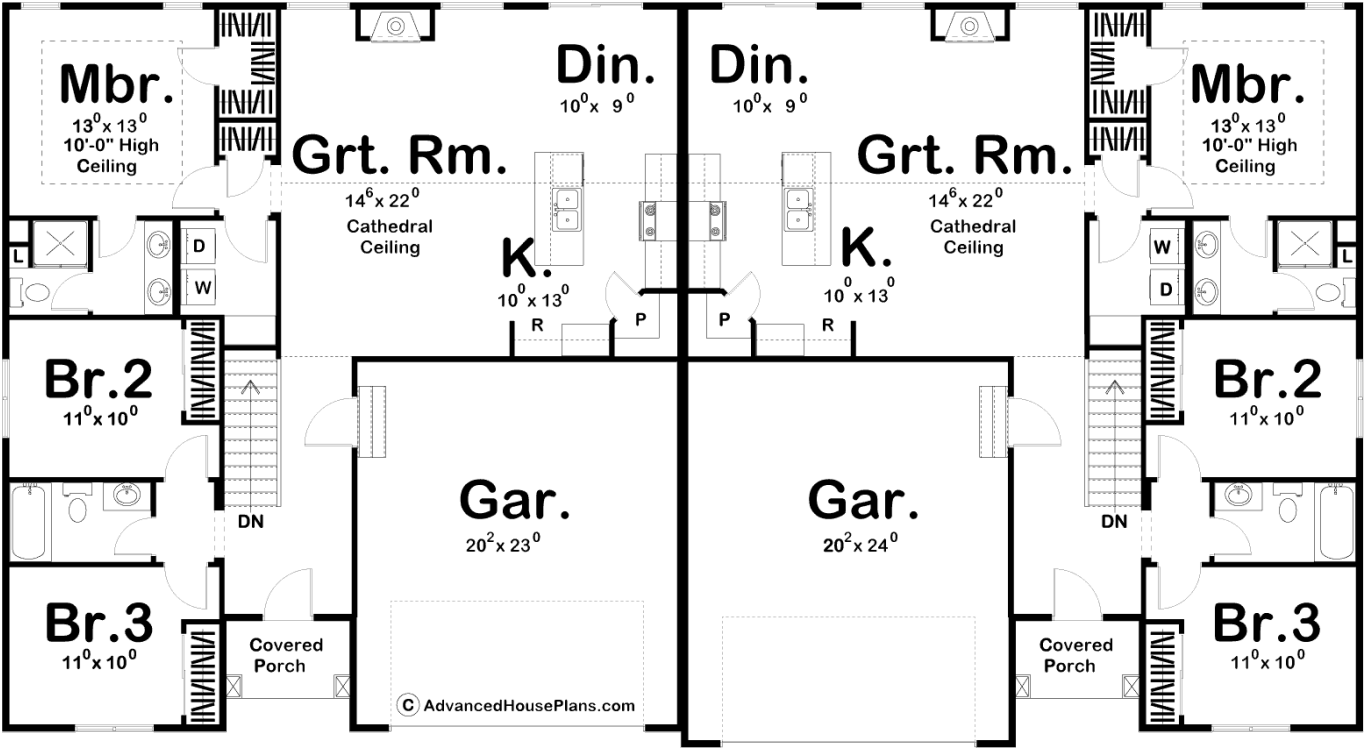

29351 - Barclay Data Sheet

1438 SQ FT	3 BEDS	2 BATHS	2 BAYS	86' 0" WIDE	47' 0" DEEP
---------------	-----------	------------	-----------	----------------	----------------



Construction Specs

Layout

Bedrooms

Bathrooms	2
Garage Bays	2
Square Footage	
Main Level	1438 Sq. Ft.
Garage	511 Sq. Ft.
Total Finished Area	1438 Sq. Ft.
Exterior Dimensions	
Width	86' 0"
Depth	47' 0"
Ridge Height <i>Calculated from main floor line</i>	28'
Default Construction Stats <i>Stats are unique to the individual plan.</i>	
Foundation Type	Basement
Exterior Wall Construction	2x4
Roof Pitches	8/12 Primary, 10/12 Secondary
Foundation Wall Height	9'
Main Wall Height	9'

Plan Description

Tasteful detailing, paired with a cost-effective foundation "footprint," make this compact, multi-story house plan a win-win for builders and buyers alike. A front entry hall, accessed from the covered front porch as well as the 2-car garage, leads to views into the great room with its cathedral ceiling, fireplace and sunny windows to the rear. The dining area and kitchen share the same space beneath the cathedral ceiling to provide an open, airy feel. The kitchen comfortably serves with an island work area, counter space, and walk-in pantry. All bedrooms reside on opposite sides of the structure for maximum privacy. The master suite features a 10-foot-high ceiling, walk-in closet and bath area with dual sinks, shower, and a compartmented bath. Bedrooms 2 and 3 share a centrally located bath. A convenient laundry area serves all bedrooms and lies just outside the master bedroom. As always any Advanced House Plans home plan can be customized to fit your needs with our alteration department. Whether you need to add another garage stall, change the front elevation, stretch the home larger or just make the home plan more affordable for your budget we can do that and more for you at Ahp. Unless you purchase an unlimited use license or a multi-use license you may only build one home from a set of plans. Plans cannot be re-sold.