

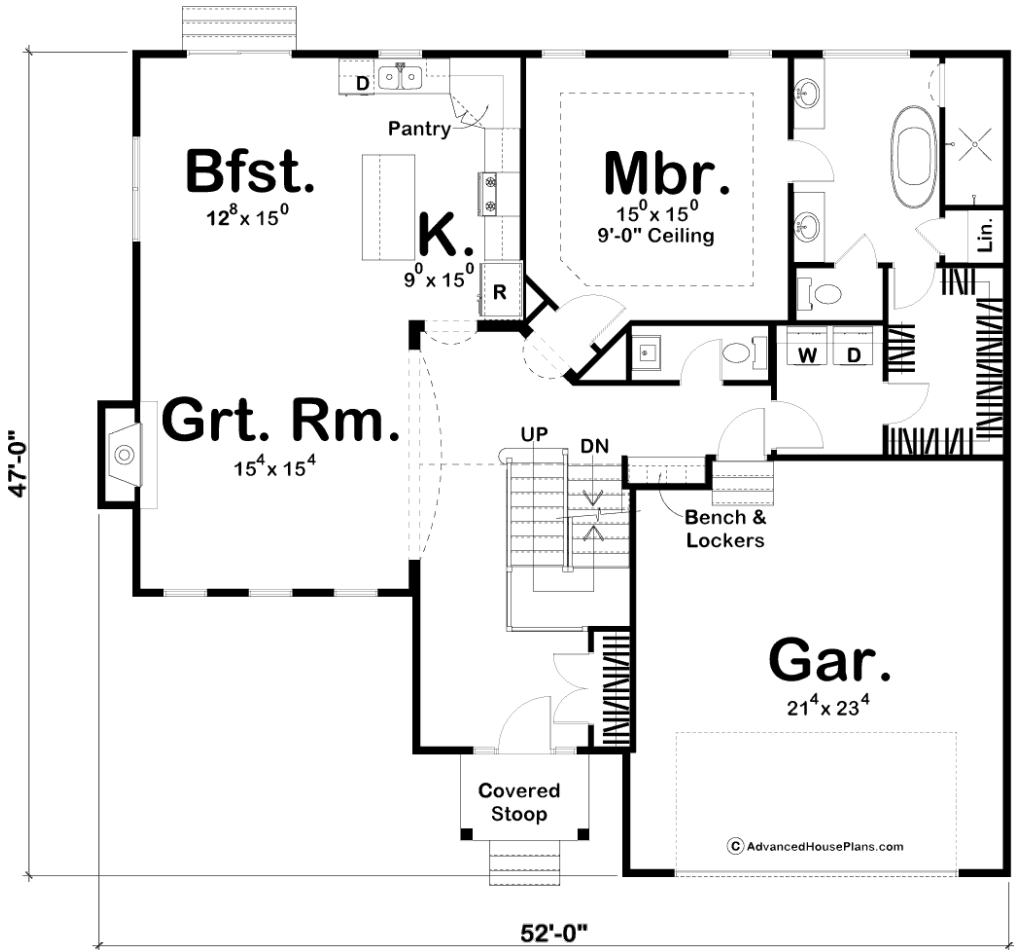

29320 - Ashworth Data Sheet

| | | | | | |
|---------------|-----------|------------|-----------|----------------|----------------|
| 2317 SQ FT | 4 BEDS | 4 BATHS | 2 BAYS | 52' 0" WIDE | 47' 0" DEEP |
|---------------|-----------|------------|-----------|----------------|----------------|

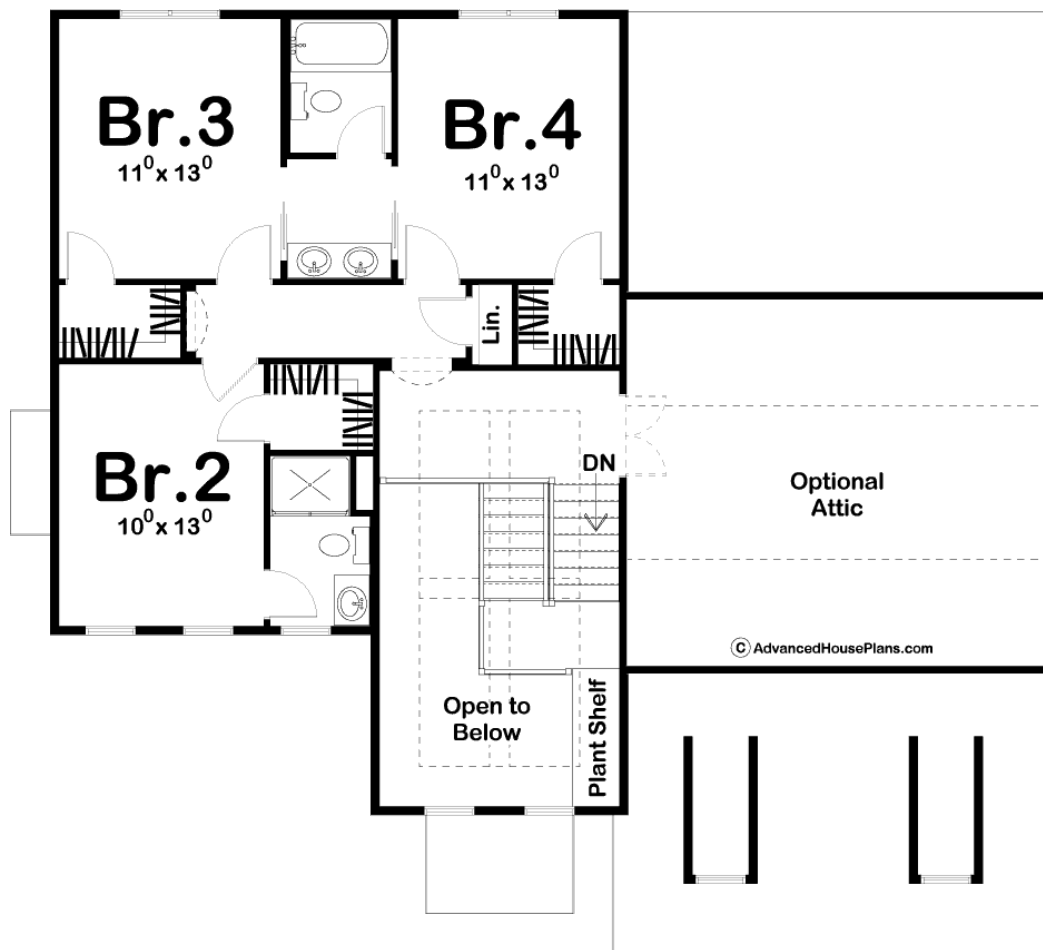



Construction Specs

Layout

| | |
|-------------|---|
| Bedrooms | 4 |
| Bathrooms | 4 |
| Garage Bays | 2 |

Square Footage

| | |
|---------------------|--------------|
| Main Level | 1508 Sq. Ft. |
| Second Level | 809 Sq. Ft. |
| Garage | 506 Sq. Ft. |
| Total Finished Area | 2317 Sq. Ft. |

Exterior Dimensions

| | |
|--|--------|
| Width | 52' 0" |
| Depth | 47' 0" |
| Ridge Height | 29' |
| <i>Calculated from main floor line</i> | |

Default Construction Stats
Stats are unique to the individual plan.

| | |
|----------------------------|----------|
| Foundation Type | Basement |
| Exterior Wall Construction | 2x4 |
| Roof Pitches | 6/12 |
| Foundation Wall Height | 9' |
| Main Wall Height | 9' |
| Second Wall Height | 8' |

Plan Description

Traditional styling, accented by charming dormers, conveys a welcoming appearance to this efficiently designed, 1.5-story home plan. Entry through the front covered stoop reveals an open arrangement of the great room, breakfast area, and kitchen. The great room is warmed by a fireplace and brightened by a trio of windows on the front wall. The kitchen itself includes a breakfast island and convenient corner pantry. The main-floor master suite is entered through an entry cove and features a 9-foot-high boxed ceiling. Its bath area features his and her vanities, walk-in shower, compartmented toilet and a walk-in closet. The walk-in closet also accesses a utility area that includes the laundry, powder bath, and mud area, featuring a bench and lockers. On a practical note, this utility area intercepts debris from the outside, as it accesses the home's 2-car garage. On the second level, three bedrooms all enjoy their own walk-in closets. Bedroom 2 has its own bath, complete with shower, while bedrooms 3 and 4 share a Jack-n-Jill bath. An optional attic area offers expansive storage space, along with countless other options for its use. As always any Advanced House Plans home plan can be customized to fit your needs with our alteration department. Whether you need to add another garage stall, change the front elevation, stretch the home larger or just make the home plan more affordable for your budget we can do that and more for you at Ahp.